

PM DC Planetary Gear Motor (Ring Gear Material: Metal)

PGM56-300K/52M95

56mm Planetary Gearbox

Permissible Load Range: 2N.m~30N.m

• Dimensions

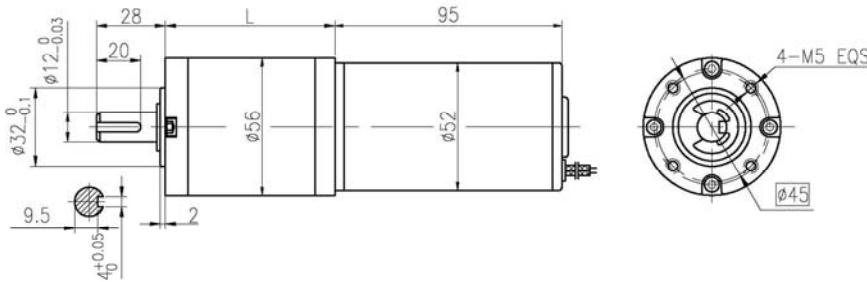

• Motor Technical Data

电机型号 TYPE	额定电压 Rated voltage VDC	空载转速 No-load speed r/min	空载电流 No-load current A	额定转速 Rated speed r/min	额定转矩 Rated torque N.m	输出功率 Output power W	额定电流 Rated current A	堵转力矩 Stall torque N.m	堵转电流 Stall current A
52M95-2430	24	3000	0.45	2300	0.12	29	1.9	0.54	9.3
52M95-2440	24	4000	0.48	3400	0.11	39	2.7	0.73	12.3

• Gear Motor Technical Data

52M95-2430 (52M95-2430 DC Motor)

减速比 Reduction ratio	3.60	4.25	13	15	18	23	47	55	65	77	96	121	153	187	220	260	307	409
减速级数 Number of gear trains	1	1	2	2	2	2	3	3	3	3	3	3	4	4	4	4	4	4
减速器长度(L) Length(L) mm	37.8	37.8	49.5	49.5	49.5	49.5	60.8	60.8	60.8	60.8	60.8	60.8	71.9	71.9	71.9	71.9	71.9	71.9
空载转速 No-load speed r/min	833	706	231	200	167	130	64	55	46	39	31	25	20	16	14	12	9.8	7.3
额定转速 Rated speed r/min	639	541	177	153	128	100	49	42	35	30	24	19	15	12	11	8.8	7.5	5.6
额定转矩 Rated torque N.m	0.39	0.46	1.4	1.6	1.7	2.2	4.6	5.3	5.7	6.7	8.4	11	13	16	17	20	24	30
最大瞬间允许负载 Max. permissible load in a short time N.m	6	6	36	36	36	36	72	72	72	72	72	72	90	90	90	90	90	90

52M95-2440 (52M95-2440 DC Motor)

减速比 Reduction ratio	3.60	4.25	13	15	18	23	47	55	65	77	96	121	153	187	220	260	307	409
减速级数 Number of gear trains	1	1	2	2	2	2	3	3	3	3	3	3	4	4	4	4	4	4
减速器长度(L) Length(L) mm	37.8	37.8	49.5	49.5	49.5	49.5	60.8	60.8	60.8	60.8	60.8	60.8	71.9	71.9	71.9	71.9	71.9	71.9
空载转速 No-load speed r/min	1111	914	308	267	222	174	85	73	62	52	42	33	26	21	18	15	13	9.8
额定转速 Rated speed r/min	944	800	262	227	189	148	72	62	52	44	35	28	22	18	16	13	11	8.3
额定转矩 Rated torque N.m	0.36	0.42	1.3	1.5	1.6	2.0	4.2	4.9	5.2	6.2	7.7	9.7	12	15	16	19	22	29
最大瞬间允许负载 Max. permissible load in a short time N.m	6	6	36	36	36	36	72	72	72	72	72	72	90	90	90	90	90	90