

PM DC Planetary Gear Motor (Ring Gear Material: Metal)

PGM36-30K/36M85P

36mm Planetary Gearbox
Permissible Load Range: 0.3N.m~3.0N.m

• Dimensions

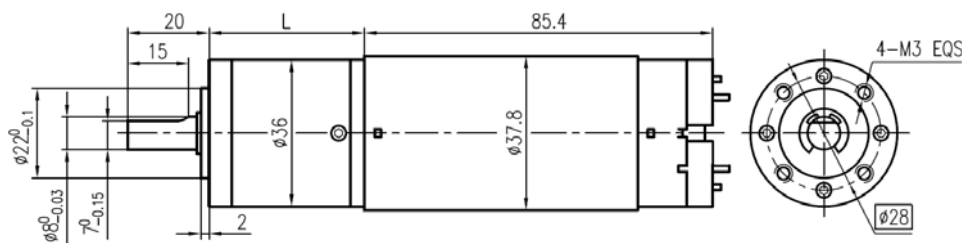

• Motor Technical Data

电机型号 TYPE	额定电压 Rated voltage VDC	空载转速 No-load speed r/min	空载电流 No-load current mA	额定转速 Rated speed r/min	额定转矩 Rated torque m.Nm	输出功率 Output power W	额定电流 Rated current A	堵转转矩 Stall torque m.Nm	堵转电流 Stall current A
36M85P-1230	12	3000	250	2400	40	10	1.60	206	6.7
36M85P-2430	24	3000	150	2500	40	10	0.85	250	4.2

• Gear Motor Technical Data

36M85P-1230 (36M85P-1230 DC Motor)

减速比 Reduction ratio	3.7	5.2	14	19	27	51	71	100	139
减速级数 Number of gear trains	1	1	2	2	2	3	3	3	3
减速器长度(L) Length(L) mm	31.0	31.0	38.5	38.5	38.5	48.4	48.4	48.4	48.4
空载转速 No-load speed r/min	809	579	214	157	111	59	42	30	21
额定转速 Rated speed r/min	649	462	171	126	89	47	34	24	18
额定转矩 Rated torque N.m	0.13	0.19	0.45	0.62	0.87	1.5	2.1	2.9	3
最大瞬间允许负载 Max. permissible load in a short time N.m	1.0	1.0	3.5	3.5	3.5	7.5	9	9	9

36M85P-2430 (36M85P-2430 DC Motor)

减速比 Reduction ratio	3.7	5.2	14	19	27	51	71	100	139
减速级数 Number of gear trains	1	1	2	2	2	3	3	3	3
减速器长度(L) Length(L) mm	31.0	31.0	38.5	38.5	38.5	48.4	48.4	48.4	48.4
空载转速 No-load speed r/min	809	579	214	157	111	59	42	30	21
额定转速 Rated speed r/min	674	483	179	132	93	49	35	25	19
额定转矩 Rated torque N.m	0.13	0.19	0.45	0.62	0.87	1.5	2.1	2.9	3
最大瞬间允许负载 Max. permissible load in a short time N.m	1.0	1.0	3.5	3.5	3.5	7.5	9	9	9